

Recommend PCB Layout

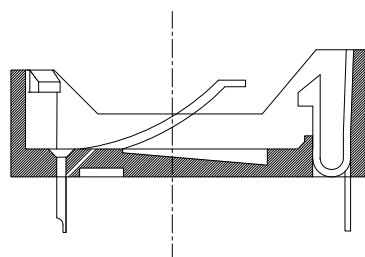

SECTION A-A

**NOTES:**

**1. Material:**

Housing: PBT+25% G.F., UL 94V-0 Rated.  
 Color: Black.  
 Contact: Brass.  
 Plating: Tin Plating(100u") over Nickel.

**2. Specification:**

Application for 3V Lithium Battery.  
 Contact Resistance: 30mΩ Max.  
 Insulation Resistance: 1000MΩ Min at 500VDC.  
 Dielectric Withstanding Voltage: 750VAC per Sec Level.  
 Durability: 50 Cycles Min.

**3. Environmental:**

Operating Temperature: -55°C to +85°C  
 ▼ Important Quality Control Dimension.

**Part Number:**

**CBAH-002RDT0-A3**

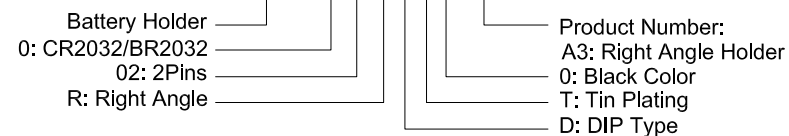

|   |          |  |            |
|---|----------|--|------------|
| A   | 07/06/07 | RELEASED FOR PRODUCTION                          |            |
| REV   | DATE     | DESCRIPTION                                      |            |
| UNLESS OTHERWISE SPECIFIED<br>DIMENSIONS ARE IN MM<br>TOLERANCES ARE: |          | CAD GENERATED DRAWING,<br>DO NOT MANUALLY UPDATE |            |
| DECIMALS  | ANGLES   | APPROVALS  | DATE       |
| .X ± .38  | ± 3°     | DRAWN Chris                                      | 07/06/07   |
| .XX ± .25   |          | CHECKED Cindy                                    | 07/06/07   |
| .XXX ± .20  |          | APPV Jason                                       | 07/06/07   |
| DO NOT SCALE DRAWING  |          | SHEET 1 OF 1                                     | SCALE NONE |
|   |          | DWG. NO. CBAT-002-0A3                            | REV. A     |



**Battery Holder, CR2032/BR2032, Right Angle, DIP(No Post)**