

Specification:

1. Rating: DC 30V 3.0A
2. Contact Resistance: 0.03Ω Max.
After Life Test: 0.05Ω Max.
3. Insulation Resistance: 100MΩ Min. (500V DC)
After Life Test: 50MΩ Min.
4. Withstand Voltage: 500V AC.
5. Insertion and Extraction Force: 3N~30N.
6. Life Test: 5,000 Cycles Min.
7. Operation Temperature Range: -20°C~70°C.
8. Respiration Temperature Range: -40°C~85°C.

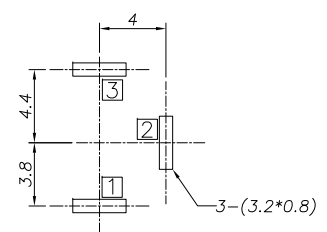

RECOMMENDED P. C. B. LAYOUT
UNSPECIFIED TOLERANCE: ±0.05
(TOP VIEW)

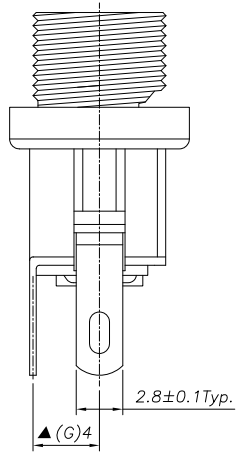
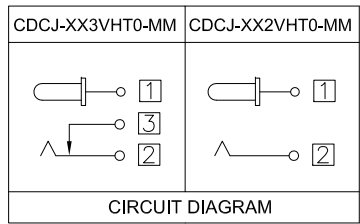
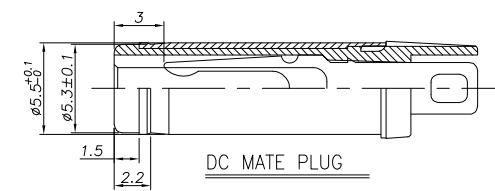
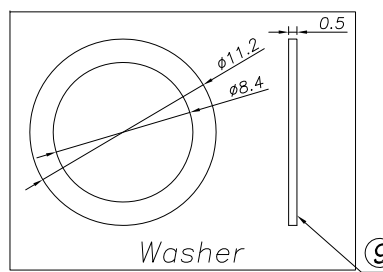

Part No.	CDCJ-20XVHT0-MM	CDCJ-23XVHT0-MM	CDCJ-25XVHT0-MM
PIN	ø2.0	ø2.35	ø2.5

Part Number:

CDCJ-XXXVHT0-MM

DC Power Jack
XX: Center Pin
20:2.00mm
23:2.35mm
25:2.50mm

MM: Product Number
0: Black Color
T: Tin Plating
H: DIP With Holes
V: Vertical Type
2: 2Pins
3: 3Pins

NO.	DESCRIPTION	QTY	MATERIAL	REMARK
9	WASHER-2	1	SPCC	Nickel Plating
8	NUT	1	BRASS	Nickel Plating
7	WASHER-1	1	BAKELITE	
6	PIN	1	PHOSPHOR BRONZE	Nickel Plating
5	BUSHING	1	BRASS	Nickel Plating
4	SHUNT TERMINAL	③	BRASS	Cu/Sn Plating
3	TIP SPRING	②	PHOSPHOR BRONZE	Cu/Sn Plating
2	CENTER PIN TERMINAL	①	BRASS	Cu/Sn Plating
1	HOUSING	1	PBT, UL94 V-0	Black

A	08/30/11	RELEASED FOR PRODUCTION	
REV	DATE	DESCRIPTION	
UNLESS OTHERWISE SPECIFIED, DIMENSIONS ARE IN MM. TOLERANCES ARE:			
DECIMALS	ANGLES	CAD GENERATED DRAWING, DO NOT MANUALLY UPDATE	
.X ± .38	± 3°	APPROVALS	DATE
.XX ± .25		DRAWN Chris	08/30/11
.XXX ± .20		CHECKED Cindy	08/30/11
DO NOT SCALE DRAWING		APPV Jason	08/30/11
		SHEET 1 OF 1	SCALE NONE
		DWG. NO. CDCJ-XXX-25M	REV. A



DESCRIPTION DC Power Jack, 2.0mm, 2.35mm or 2.5mm Center Pin, Vertical, DIP With Holes, With Screw L=5.7mm, Black Color