

Pin Number	Signal Name	Pin Number	Power Line Designation
S1	GND	P1	DP
S2	A+	P2	+5V
S3	A-	P3	+5V
S4	GND	P4	MD
S5	B-	P5	GND
S6	B+	P6	GND
S7	GND		

**NOTES:**

**1. Material:**

Housing: LCP+50%G.F, UL 94V-0 rated.  
 Color: Black.  
 Contact: Brass.  
 Plating: Gold plating over Nickel on contact area;  
 Tin plating on solder tail.  
 Harpoon: Brass.  
 Plating: Tin plating over Nickel.

**2. Mechanical:**

Insertion Force: 45N max.  
 Withdrawal Force: 10N min.  
 Durability: 500 cycles

**3. Electrical Specification:**

Current Rating: 1.5 Ampere per contact.  
 Contact Resistance: 30 mΩ max.  
 Insulation Resistance: 1000 MΩ min.  
 Dielectric Withstanding Voltage: 500 V AC.

**4. Environmental:**

Operating Temperature: 0°C to +85°C

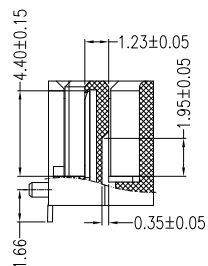
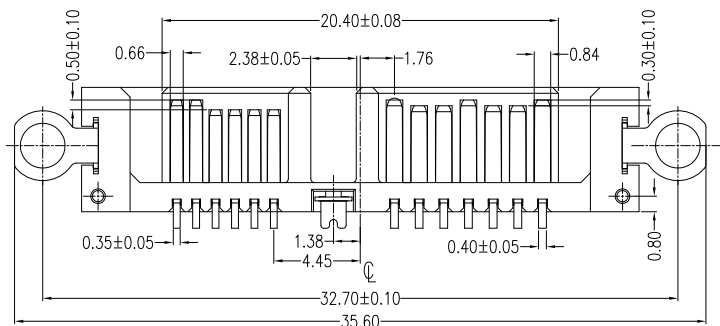

Section:A-A

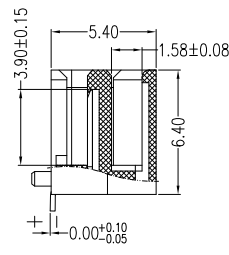

Section:B-B

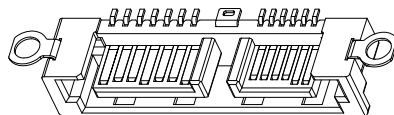
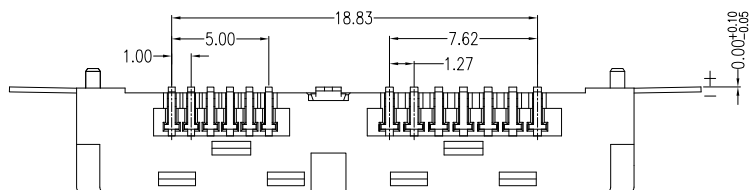

Part Number:

**CSAT-M13RS30-Q3**

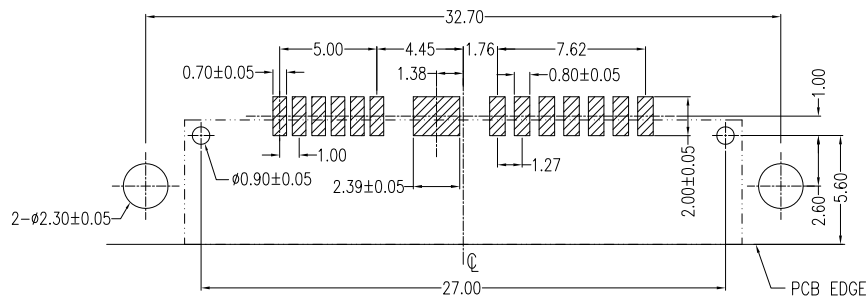
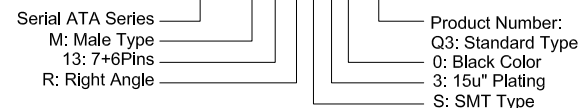

P.C.B LAYOUT(T=1.60mm)  
COMPONENT SIDE

A	03/14/11	RELEASED FOR PRODUCTION		DESCRIPTION	
REV	DATE	DESCRIPTION			
UNLESS OTHERWISE SPECIFIED DIMENSIONS ARE IN MM TOLERANCES ARE:		CAD GENERATED DRAWING, DO NOT MANUALLY UPDATE			
DECIMALS	ANGLES	APPROVALS	DATE		
.X ± .38	± 3°	DRAWN	Chris	03/14/11	
.XX ± .25		CHECKED	Cindy	03/14/11	
.XXX ± .20		APPV	Jason	03/14/11	
DO NOT SCALE DRAWING		SHEET	1 OF 1	SCALE	NONE
		DWG. NO.	CSAT-M22-0C5		REV. A



**凱聯科技股份有限公司**  
**Conn-Link Technology Inc.**

**Slim Line SATA 7+6P, Male, Right Angle Standard, SMT, H:5.4mm High**