

Pin Number	Signal Name	Description
S1	GND	
S2	A+	Differential Signal
S3	A-	
S4	GND	
S5	B-	Differential Signal
S6	B+	
S7	GND	

Pin Number	Power Designation
P1	+3.3V
P2	+3.3V
P3	GND
P4	GND
P5	+5V
P6	+5V
P7	Reserved
P8	Optional
P9	Optional

**NOTES:**

**1. Material:**  
 Housing: LCP+50%G.F, UL 94V-0 Rated.  
 Color: Black.  
 Contact: Brass.  
 Plating: Gold Plating over Nickel on Contact Area.  
 Tin Plating on Solder Tail.

**2. Mechanical:**  
 Insertion Force: 45N Max.  
 Withdrawal Force: 10N Min.  
 Durability: 500 Cycles

**3. Electrical Specification:**  
 Operation Voltage: 100VAC Max.  
 Current Rating: 1.5 Ampere per Contact.  
 Contact Resistance: 30mΩ Max.  
 Insulation Resistance: 1000MΩ Min.  
 Dielectric Withstanding Voltage: 500 VAC.

**4. Environmental:**  
 Operating Temperature: -55°C to +85°C

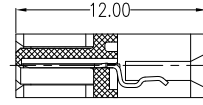
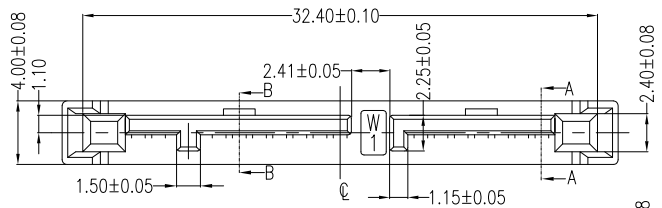

Section:A-A

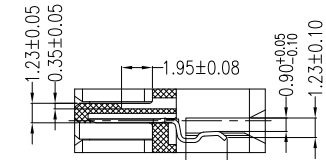

Section:B-B

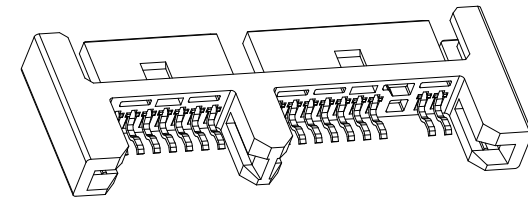
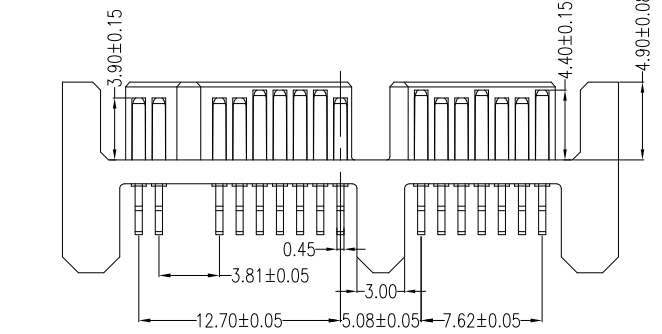

Product 3D

**Part Number:**

**CSAT-M16SS30-V7**

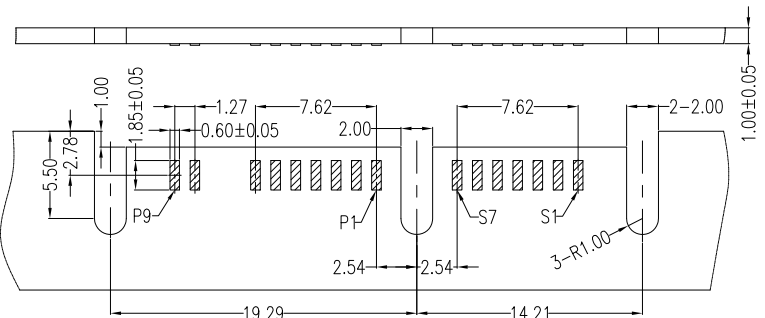
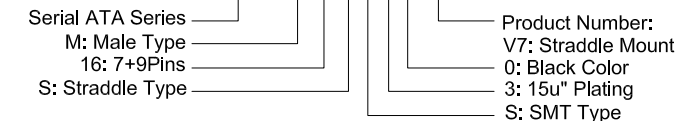

RECOMMENDED PCB LAYOUT

A	06/01/09	RELEASED FOR PRODUCTION	
REV	DATE	DESCRIPTION	
UNLESS OTHERWISE SPECIFIED DIMENSIONS ARE IN MM TOLERANCES ARE:		 <b>凱聯科技股份有限公司</b> <b>Conn-Link Technology Inc.</b>	
DECIMALS	ANGLES		
.X ± .38	± 3°		
.XX ± .25			
.XXX ± .20		APPROVALS	DATE
DO NOT SCALE DRAWING		DRAWN	Chris 06/01/09
		CHECKED	Cindy 06/01/09
		APPV	Jason 06/01/09
		SHEET	1 OF 1
		SCALE	NONE
		DWG. NO.	CSAT-M16-V07
		REV.	A