

Signal Segment	
Name	Type
S1	GND
S2	A+
S3	A-
S4	GND
S5	B-
S6	B+
S7	GND

Power Segment	
Name	Type
P1	V33
P2	V33
P3	V33
P4	GND
P5	GND
P6	GND
P7	V5
P8	V5
P9	V5
P10	GND
P11	DAS/DSS
P12	GND
P13	V12
P14	V12
P15	V12

NOTES:

1. Material:

Housing: LCP+50%G.F, UL 94V-0 rated.
 Color: Black.
 Contact: Brass.
 Plating: Gold plating over Nickel(40~80u") on contact area; Tin plating(100~250u") on solder tail.
 Harpoon: Brass.
 Plating: Tin plating(100~250u") over Nickel(40~80u").

2. Mechanical:

Insertion Force: 45N max.
 Withdrawal Force: 10N min.
 Durability: 500 cycles

3. Electrical Specification:

Current Rating: 1.5 Ampere per contact.
 Contact Resistance: 30 mΩ max.
 Insulation Resistance: 1000 MΩ min.
 Dielectric Withstanding Voltage: 500 V AC.

4. Environmental:

Operating Temperature: -55°C to +85°C

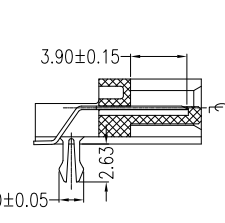
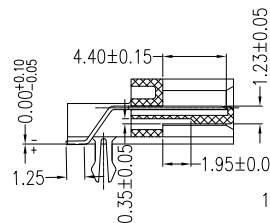
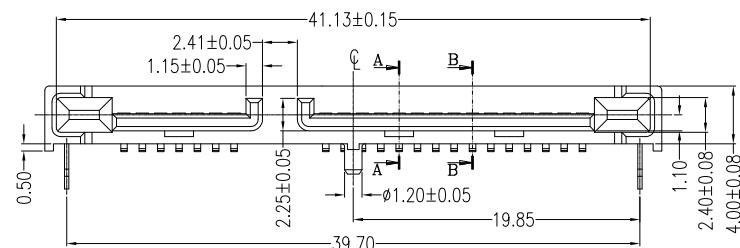

SECT A-A

SECT B-B

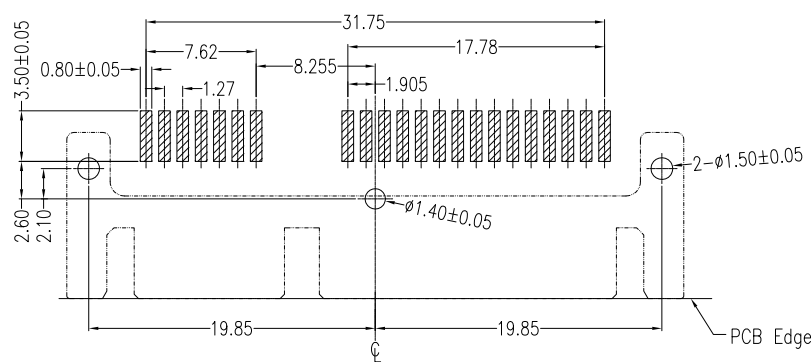

PCB Layout (T=1.60±0.05mm)
Top View

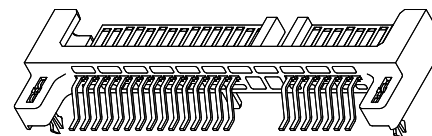

Part Number:

CSAT-M22RS30-R5

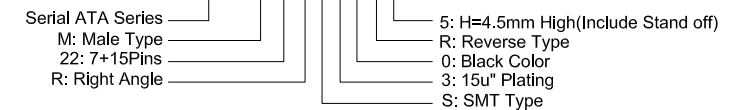

A	01/11/10	RELEASED FOR PRODUCTION	
REV	DATE	DESCRIPTION	
UNLESS OTHERWISE SPECIFIED DIMENSIONS ARE IN MM TOLERANCES ARE:		CAD GENERATED DRAWING, DO NOT MANUALLY UPDATE	
DECIMALS	ANGLES	APPROVALS	DATE
.X ± .38	± 3°	DRAWN	Chris 01/11/10
.XX ± .25		CHECKED	Cindy 01/11/10
.XXX ± .20		APPV	Jason 01/11/10
DO NOT SCALE DRAWING	SHEET 1 OF 1	SCALE NONE	DWG. NO. CSAT-M22-0C5
		 Serial ATA 7+15P, Male, Right Angle Reverse, SMT, H:4.5mm High	
			REV. A