

Signal Segment	
Name	Type
S1	GND
S2	A+
S3	A-
S4	GND
S5	B-
S6	B+
S7	GND

Power Segment			
Name	Type	Name	Type
P1	V33	P9	V5
P2	V33	P10	GND
P3	V33	P11	DAS/DSS
P4	GND	P12	GND
P5	GND	P13	V12
P6	GND	P14	V12
P7	V5	P15	V12
P8	V5		

NOTES:

1. Material:

Housing: LCP+50%G.F, UL 94V-0 Rated.
 Color: Black.
 Contact: Phosphor Bronze.
 Plating: Gold Plating over Nickel on Contact Area.
 Tin(100u" Min.) Plating on Solder Tail.
 Nickel (40u" Min.) Underplating overall.

2. Mechanical:

Insertion Force: 45N Max.
 Withdrawal Force: 10N Min.
 Durability: 500 Cycles

3. Electrical Specification:

Operation Voltage: 100VAC Max.
 Current Rating: 1.5 Ampere per Contact.
 Contact Resistance: 30mΩ Max.
 Insulation Resistance: 1000MΩ Min.
 Dielectric Withstanding Voltage: 500 VAC.

4. Environmental:

Operating Temperature: -55°C to +85°C

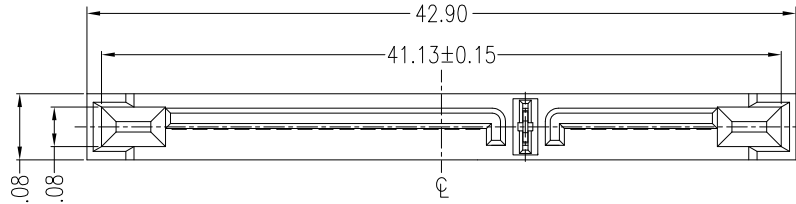

Part Number	Dim*A*
CSAT-M22VD30-HE	2.10mm
CSAT-M22VD30-HF	3.00mm

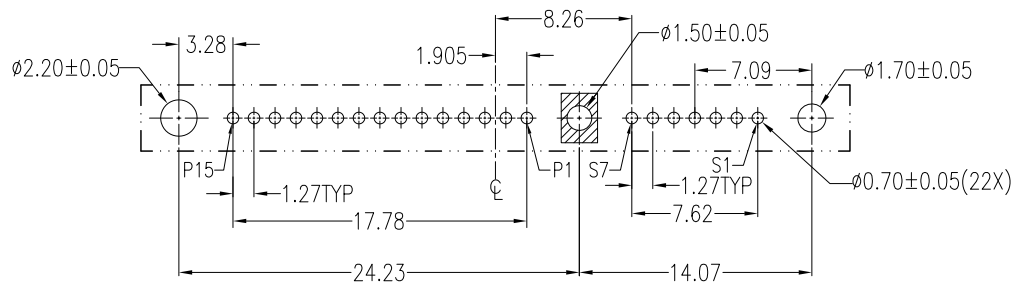
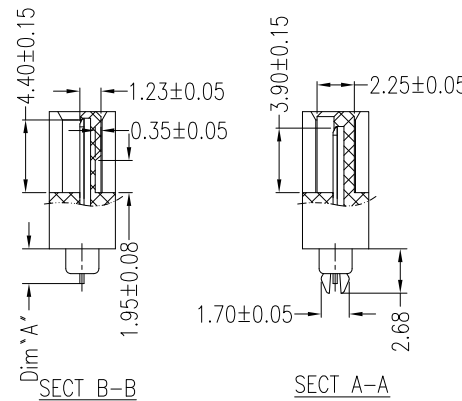
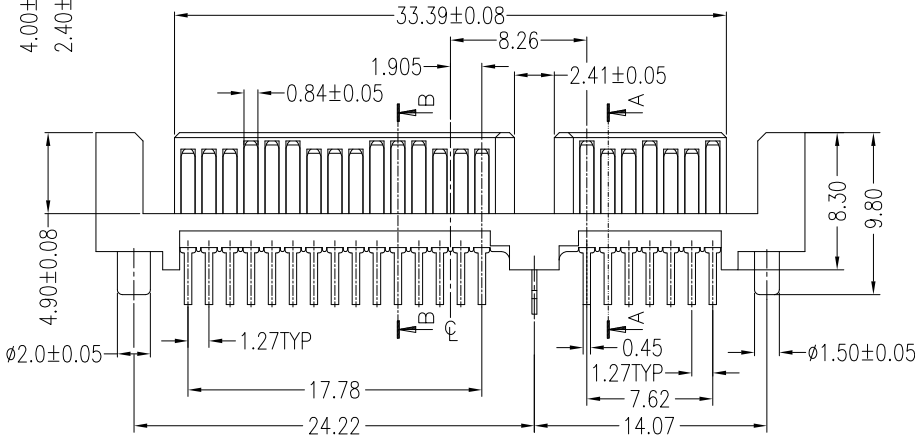

P.C.B LAYOUT(T=1.60mm)
COMPONENT SIDE

Part Number:

CSAT-M22VD30-HE

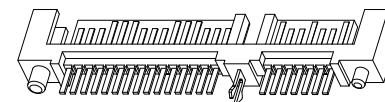
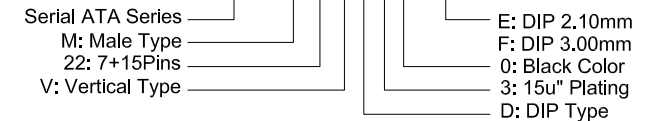

A	08/03/10	RELEASED FOR PRODUCTION		DESCRIPTION	
REV	DATE	UNLESS OTHERWISE SPECIFIED, DIMENSIONS ARE IN MM. TOLERANCES ARE:			
		APPROVALS		DATE	
		DRAWN	Chris	08/03/10	
		CHECKED	Cindy	08/03/10	
		APPV	Jason	08/03/10	
DO NOT SCALE DRAWING		SHEET	1 OF 1	SCALE	NONE
		DWG. NO.	CSAT-M22-0HE		REV. A



Serial ATA 7+15P, Male, Vertical Type
Single Row, DIP 2.10mm