

RECOMMENDED PCB LAYOUT(BOTTOM VIEW)

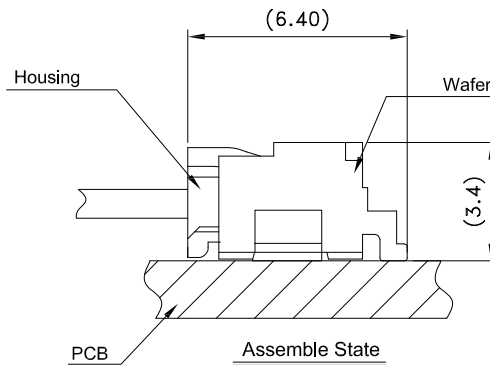

NOTES:

1. Material:

- Housing: Nylon 46, UL 94V-0 Rated.
- Color: White.
- Contact: Brass.
- Plating: Tin Plating over Nickel.
- Solder Nail: Brass.
- Plating: Tin Plating over Nickel.

2. Electrical Specification:

- Operation Voltage: 125V AC/DC.
- Current Rating: 1 Ampere AC/DC per Contact.
- Contact Resistance: 20mΩ Max.
- Insulation Resistance: 100MΩ Min.
- Dielectric Withstanding Voltage: 250V AC per Minute.

3. Environmental:

- Operating Temperature: -40°C to +85°C.
- Package: 1,500pcs/Reel.

Poles	Part Number	Dimensions (mm)			
		A	B	C	D
2	CW12-M02RST1-H7	1.25	4.25	3.05	7.10
3	CW12-M03RST1-H7	2.50	5.50	4.30	8.35
4	CW12-M04RST1-H7	3.75	6.75	5.55	9.60
5	CW12-M05RST1-H7	5.00	8.00	6.80	10.85
6	CW12-M06RST1-H7	6.25	9.25	8.05	12.10
7	CW12-M07RST1-H7	7.50	10.50	9.30	13.35
8	CW12-M08RST1-H7	8.75	11.75	10.55	14.60
9	CW12-M09RST1-H7	10.00	13.00	11.80	15.85
10	CW12-M10RST1-H7	11.25	14.25	13.05	17.10
11	CW12-M11RST1-H7	12.50	15.50	14.30	18.35
12	CW12-M12RST1-H7	13.75	16.75	15.55	19.60
13	CW12-M13RST1-H7	15.00	18.00	16.80	20.85
14	CW12-M14RST1-H7	16.25	19.25	18.05	22.10
15	CW12-M15RST1-H7	17.50	20.50	19.30	23.35

Part Number:

CW12-MXXRST1-H7

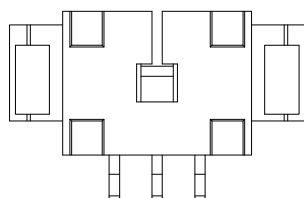
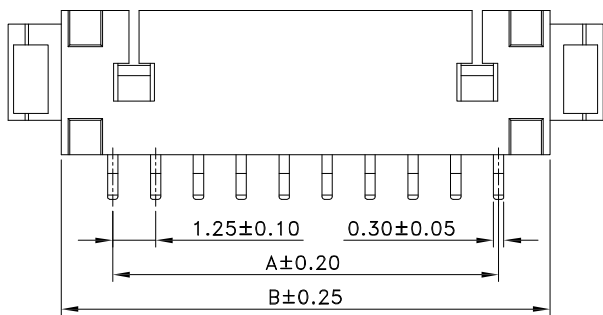
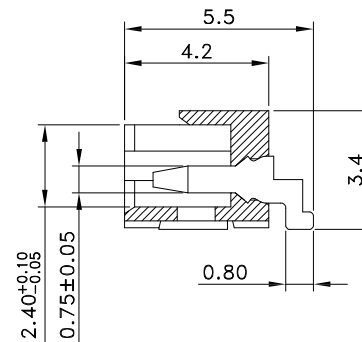
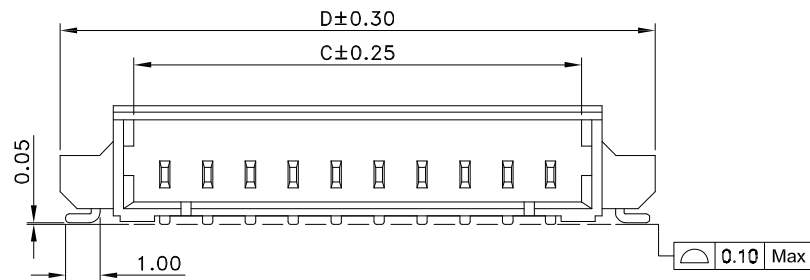
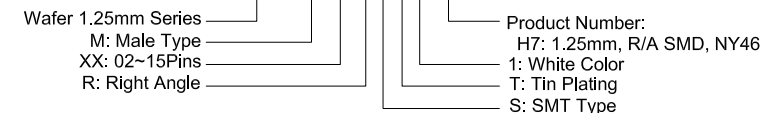

3 Circuit

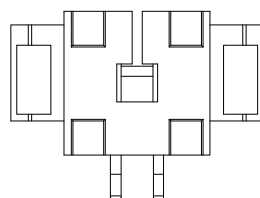

2 Circuit

A	11/21/12	RELEASED FOR PRODUCTION	
REV	DATE	DESCRIPTION	
UNLESS OTHERWISE SPECIFIED, DIMENSIONS ARE IN MM. TOLERANCES ARE:		CAD GENERATED DRAWING, DO NOT MANUALLY UPDATE	
DECIMALS	ANGLES	APPROVALS	DATE
.X ± .38	± 3°	DRAWN Chris	11/21/12
.XX ± .25		CHECKED Cindy	11/21/12
.XXX ± .20		APPV Jason	11/21/12
DO NOT SCALE DRAWING	SHEET 1 OF 1	SCALE NONE	DWG. NO. CW12-MXX-0H7
		DESCRIPTION Wire to Board, 1.25mm Crimp Style Connector Wafer, Right Angle, SMT 02~15Pins, White	
		REV. A	

